



Office of Communications
803 W. Broad Street, Suite 340
Falls Church, VA 22046
703-248-5600

September 2, 2005

Student Transportation to School: **Thomas Jefferson Elementary**

TJ Tiger Trails for walkers:

As a result of last year's Elementary PTA's Neighborhood Safety Study, many new stop signs and crosswalks have been added to enhance the safety of students who walk to school. The **Tiger Trail Map** shows the trails and crosswalks in the neighborhood around the school. Whenever possible, students should walk on sidewalks and follow a designated Tiger Trail to school and home from school.

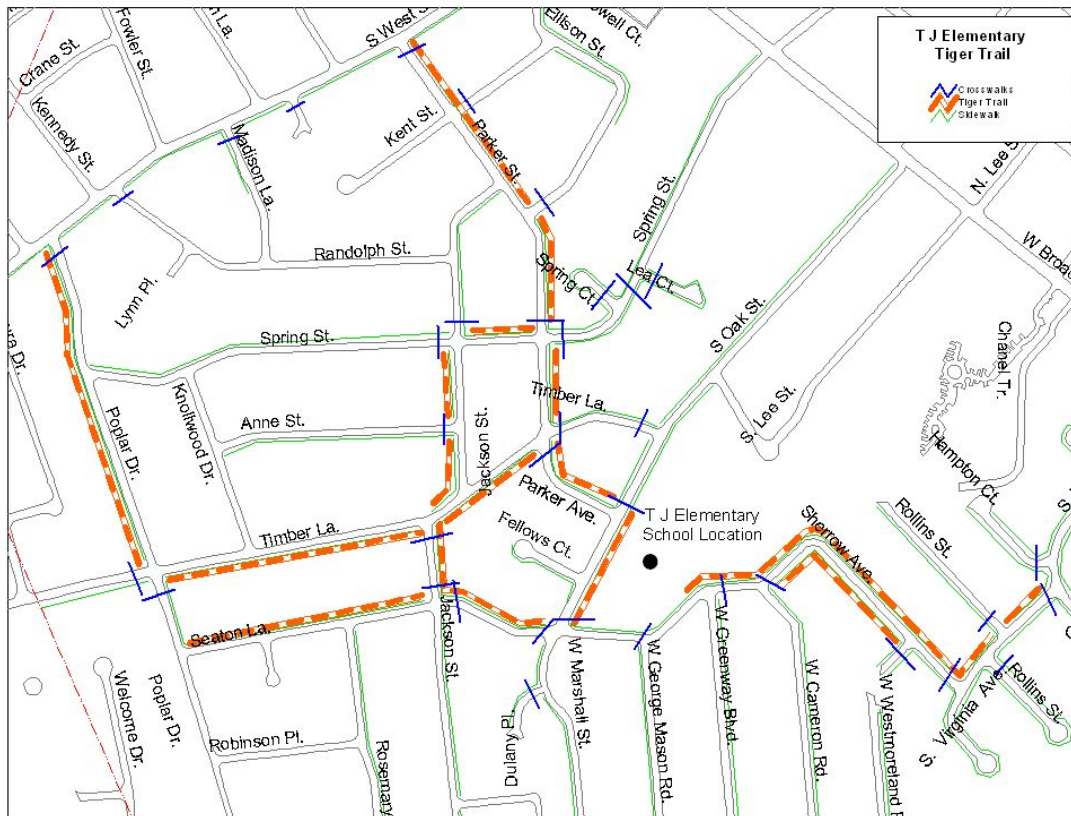

(Continued on page 2)

Parents Arriving With Students (PAWS) by Car:

Oak Street (front of school):

During arrival and dismissal times, the front of the school is limited to bus traffic only. To increase safety and ease congestion, please follow the new one-way traffic pattern along South Oak Street, Parker Avenue and Timber Lane (see **TJ Drop Off Map**). This new traffic flow will allow parents to drop off and pick up students at the supervised PAWS area in front of the trailers on the school side of Oak Street. If your child is not in the PAWS area when you drive up, please circle the block so that traffic will continue to flow.

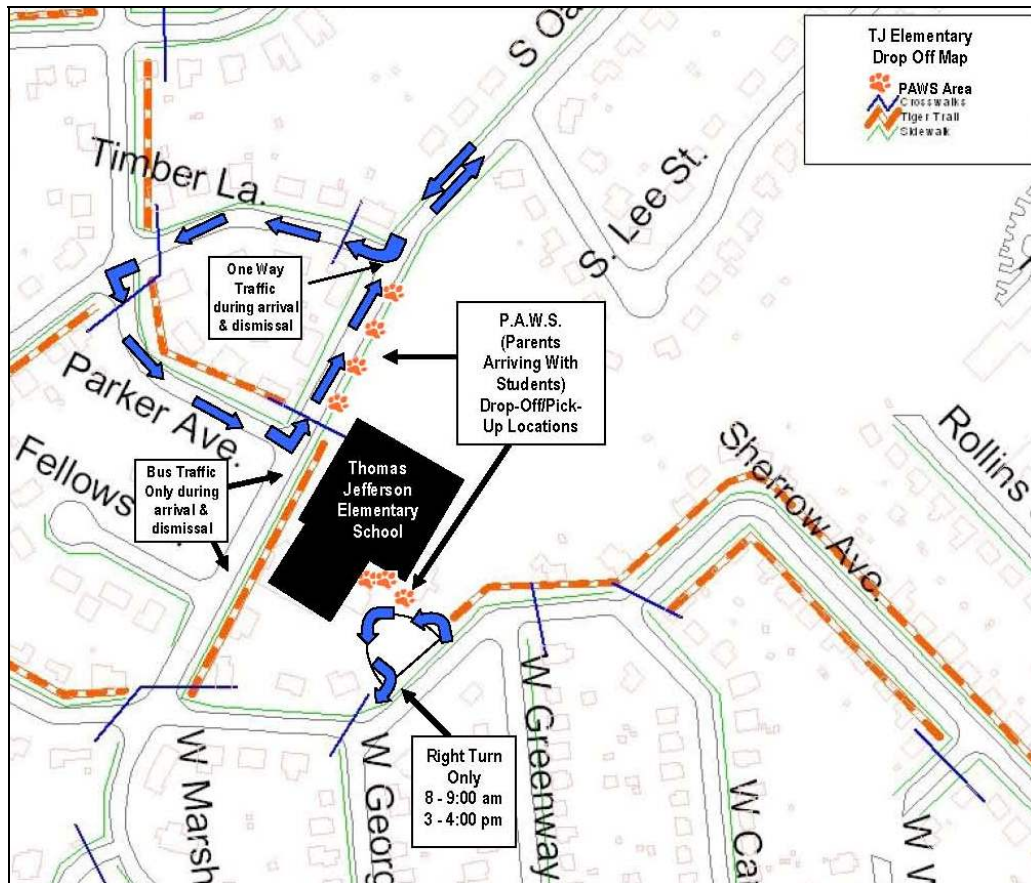

Seaton Lane (behind the school):

The one way traffic circle in the back of the building will allow a single lane of traffic to drop off or pick up students. For safety and smooth traffic flow, when exiting, traffic may only make a right turn onto Seaton Lane.

Please be sure that your child or your child's teacher knows whether they should be escorted to the Oak Street or to the Seaton Lane dismissal area.

###